

# AC 75R / S Strip

**AGILE-CORE™**  
Distributed Edge Architecture

PROJECT:

QTY:

TYPE:

CATALOG:

## SPECIFICATIONS:

<b>Housing</b>	22-gauge die-formed C.R.S.
<b>Shielding</b>	Diffuse acrylic lens. Frosted polycarbonate available for 75R.
<b>Finish</b>	White polyester powder coat. Painted after fabrication.
<b>Electrical</b>	High-quality mid power LED board.
<b>Mounting</b>	Surface (ceiling or wall) or suspended (hanging hardware required)
<b>Listings</b>	<ul style="list-style-type: none"><li>• cETLus conforms to UL STD 1598. Certified to CAN/CSA STD C22.2 No. 250.0. Suitable for damp locations.</li><li>• Complies with the Buy American Act and other federal regulations.</li></ul>
<b>Warranty</b>	5-year limited warranty



## FEATURES:

- Maximum energy savings with efficacies up to 203 lm/W
- No in-luminaire drivers extending fixture life, using less materials and lowering costs
- Daisy chain multiple fixtures per home run
- Compatible with cat 6 patch cables when used with XPD accessory
- Small fixture profile allows inconspicuous placement in coves or confined spaces
- Row applications produce continuous light with minimal interruption between fixtures
- Made in the USA

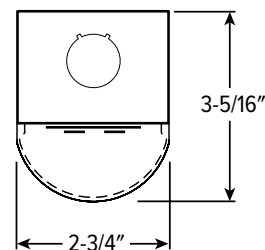

75R Shown

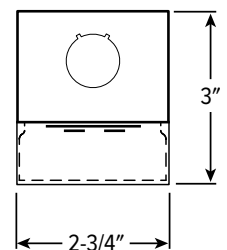

75S Shown

## CERTIFICATIONS



## ORDERING GUIDE:

Example Catalog # AC 75R 4 P77/835 FL VBY ACF/D48

Family	Length	Lumens	/ CRI	CCT	Pwr/Control	Options
AC 75R Round Lens	2 2'	2' P20 1,994lm P39 3,853lm P57 5,640lm	8 80	27 2700K 30 3000K 35 3500K 40 4000K 50 5000K	FL flying leads AGILE-CORE™ ready	WG-75 11-gauge white powder coat wireguard *
AC 75S Square Lens	4 4' 8 8'	4' P40 3,987lm P77 7,705lm P113 11,279lm	9 90	TW 3000-5000K		315 1-1/2" ceiling spacer
		8' P80 7,975lm P117 11,724lm P226 22,560lm		TW2 2700-6500K		VBY (2) Y-hangers
						VBY-2 (2) Y-hangers and (2) 2' chains
						RA-75 Row aligner **
						45AMB (2) 45 degree adjustable mounting brackets ***

## AIRCRAFT CABLES

Example: ACF/D48\*\*\*\*

Prefix	Type	Length
ACF/ Feeder	D 1" grid & hardpan	24 24"
ACJ/ Joiner	N 9/16" grid	48 48"
	S Slot grid	96 96"

## ACCESSORIES

ordered separately

XPD-P2H-G	Adapter - (2) RJ45 & (1) 2 CH terminal block
-----------	--

\* Ships separately, field-installed. Not available with special reflectors.  
 \*\* Required when row mounting with aircraft cables.  
 \*\*\* Field-adjustable up and down in 7-1/2" increments.  
 \*\*\*\* Requires RA-75 row aligner. Must specify low-voltage cord.

## PERFORMANCE TABLE

AC 75R/S @ 80CRI, 3500K

	LED Package	Delivered Lumens	Wattage	Efficacy (lm/W)	Control	LED Channels	LED Vf max (V)	LED If max/ch (mA)
2'	P20	1994	9.8	203	sold separately	1	37	260
	P39	3853	19.8	195		1	38	520
	P57	5640	30	188		1	39	776
4'	P40	3987	19.7	202		1	37	537
	P77	7705	39.6	195		2	38	527
	P113	11279	60	188		1	39	1552
8'	P80	7975	39.3	203		2	38	527
	P117	11724	59.1	198		1	39	1552
	P226	22560	118.8	190		2	39	1552

AC 75S TUNABLE WHITE

	LED Package	Delivered Lumens	Wattage	Efficacy (lm/W)	Control	LED Channels	LED Vf max (V)	LED If max/ch (mA)
2'	P20	2057	9.8	210	sold separately	2	37	260
	P39	3974	19.8	201		2	38	520
	P57	5817	30	194		2	39	776
4'	P40	4112	19.7	209		2	37	537
	P77	7947	39.6	201		4	38	527
	P113	11633	60	194		2	39	1552
8'	P80	8225	39.3	209		4	38	527
	P117	12092	59.1	205		2	39	1552
	P226	23268	118.8	196		4	39	1552

MULTIPLIER TABLE - 80 CRI

Color Temperature			
CCT	Standard	TW	TW2
2700K	0.97	-	0.93
3000K	0.99	0.95	0.95
3500K	1.00	0.98	0.98
4000K	1.03	1.00	1.00
5000K	1.06	0.96	1.02
6500K	-	-	1.01

MULTIPLIER TABLE - 90 CRI

Color Temperature			
CCT	Standard	TW	TW2
2700K	0.80	-	0.93
3000K	0.82	0.91	0.95
3500K	0.83	0.96	0.98
4000K	0.86	1.00	1.00
5000K	0.89	1.03	1.03
6500K	-	-	1.02

- Photometrics tested in accordance with IESNA LM-79. Results based on 80 CRI, 3500K CCT static white, 4000K CCT tunable white, and 25°C ambient temperature. Actual performance may vary +/-5%.
- Use multiplier table to calculate additional options.

TW

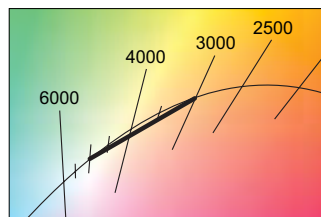

TW2

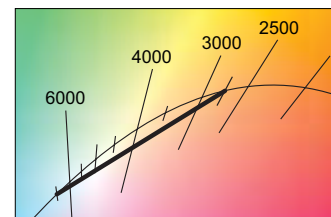

## FIXTURE DETAILS

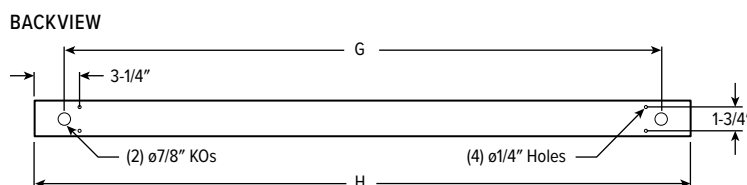
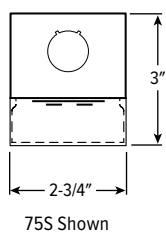
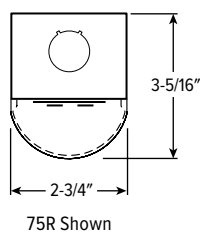

MOUNTING DETAILS

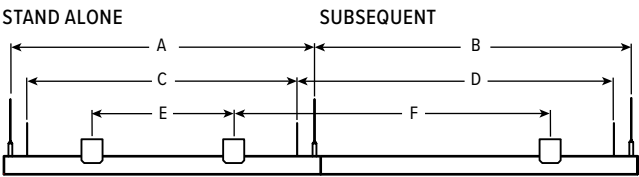

		AIRCRAFT CABLE		VBY HANGER		315 SPACER	
		A	B	C	D	E	F
2'		21-1/2"	22-1/2"	19"	22-1/2"	10"	22-1/2"
4'		43-5/8"	44-5/8"	41-1/4"	44-5/8"	32"	44-5/8"
8'		88-3/16"	89-1/4"	85"	89-1/4"	77"	89-1/4"

STANDARD HARDWARE FOR SUSPENDED PRODUCT (Grid and Hardpan)

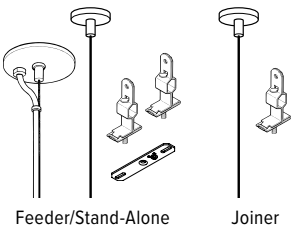

- Notes:
- Fixtures are provided with adjustable length aircraft cables and mounting hardware, must specify.
  - Power is brought into the feeder fixture, either as part of a row or as a stand-alone unit. Joiner fixtures complete the row. One power drop per node required.

LOW-VOLTAGE CORD OPTIONS  
Must specify low-voltage cord when cable mounting.

ORDERING EXAMPLE: P24/W		
CORD TYPE	LENGTH	COLOR
P PoE	24 24"	/W White
	48 48"	/B Black
	96 96"	

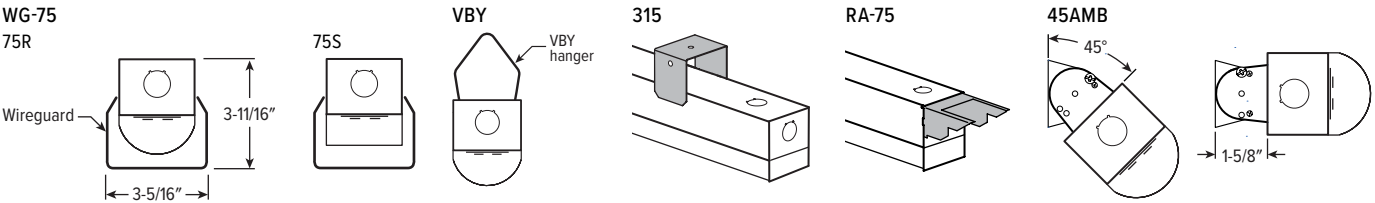

FINISH OPTIONS

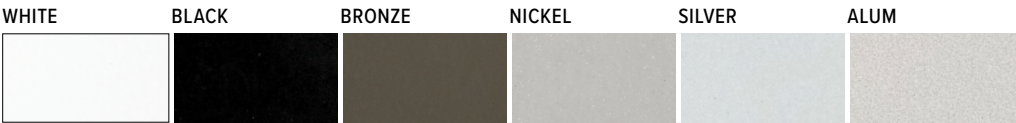

For custom color, please specify RAL code or a manufacturer code with description. All custom colors other than RAL require two sample swatches, minimum 1" square.

## AGILE-CORE POWER DISTRIBUTION AND CONTROL SYSTEM

