

AC LRX5 5" Wide Linear Recessed

AGILE-CORE™
Distributed Edge Architecture

PROJECT:

QTY:

TYPE:

CATALOG:

SPECIFICATIONS:

Housing	22-gauge die-formed, C.R.S.
Shielding	Lift-and-shift flat diffuse matte acrylic, .080" thick.
Finish	92% minimum average reflective white polyester powder coat bonded to phosphate-free, multi-stage pretreated metal. All parts painted after fabrication to facilitate installation, increase efficiency, and inhibit corrosion.
Electrical	High-quality mid-power LED boards. L70 >50,000 hours.
Mounting	NEMA Type "G" 15/16" or 1" grid standard. 9/16" narrow-face grid and drywall flange types available.
Listings	<ul style="list-style-type: none">• cCSAus certified as luminaire suitable for dry or damp locations.• City of Chicago Environmental Air approved when specified with CP option.• IC-rated for direct contact with insulation.• Complies with the Buy American Act and other federal regulations.
Warranty	5-year limited warranty

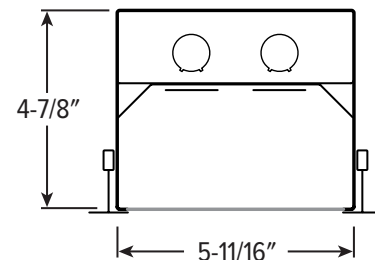
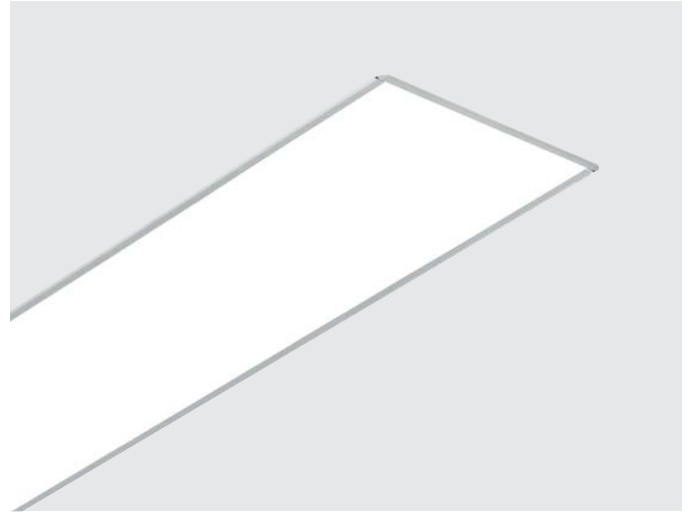

FEATURES:

- Maximum energy savings with efficacies up to 162 lm/W
- No in-luminaire drivers extending fixture life, using less materials and lowering costs
- Daisy chain multiple fixtures per home run
- No field wiring when used with cat 6 patch cables and luminaires with RJ45 power connections
- For use as stand-alone fixture or in continuous rows
- Grid or hardpan ceilings
- Made in the USA

CERTIFICATIONS



AC LRX5 5" Wide Linear Recessed

AGILE-CORE™
Distributed Edge Architecture

ORDERING GUIDE:

Example Catalog # AC LRX5G 4 L10/835 DMA RJ45

Family	Fixture Style	Length	Lumens ¹ /	CRI	CCT	Shielding	Pwr/Control
AC LRX5	G 15/16" or 1" grid ²	Stand-alone 2', 4', 6' & 8' nominal lengths, fixture ships assembled. Example: 4 = 4'	L8 800lm L12 1200lm L16 1600lm L23 2300lm	8 80 9 90 ³	27 2700K 30 3000K 35 3500K 40 4000K 50 5000K	DMA Diffuse matte acrylic lens, 0.80" thick	RJ45 two XPD T2P G RJ45 connectors FL flying leads
	N 9/16" Narrow grid ²	Row-mount Lengths specified in 2' increments. Example: 12 = 12'					
	F Flange						

¹ Lumens per foot output based on 80 CRI/3500K CCT. Actual lumens may vary +/-5%. See page 2 for FIXTURE PERFORMANCE DATA. Additional lumen packages available, see Options.

² Field-installed earthquake clips provided.

³ Extended lead times may apply. Consult factory for availability.

PERFORMANCE TABLE

LRX4 @ 80CRI, 3500K, per foot

	Delivered Lumens	Wattage	Efficacy (lm/W)	Control up to 10'	LED Channels*	LED Vf max (V)	LED If max/ch (mA)
L8	809	5	162	(2) XPD-T2P-G	varies	33	78
L12	1206	7.5	161		varies	33	114
L16	1567	10	157		varies	33	150
L23	2301	15	153		varies	34	222

* Consult factory for # of channels

MULTIPLIER TABLE

	Color Temperature	
	CCT	Conversion Factor
80 CRI	2700K	0.97
	3000K	0.99
	3500K	1.00
	4000K	1.03
	5000K	1.06
90 CRI	2700K	0.80
	3000K	0.82
	3500K	0.83
	4000K	0.86
	5000K	0.89

- Photometrics tested in accordance with IESNA LM-79. Results based on 80 CRI/3500K CCT, and 25°C ambient temperature. Actual performance may vary +/-5%
- Use multiplier table to calculate additional options.

FIXTURE DETAILS

BACKVIEW

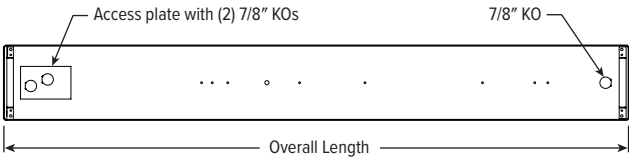

	Overall Length
2'	23-13/16"
4'	47-13/16"
6'	71-13/16"
8'	95-13/16"

LRX5G

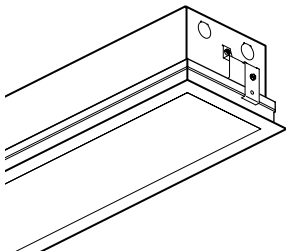
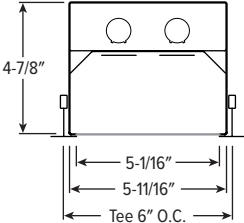

LRX5N

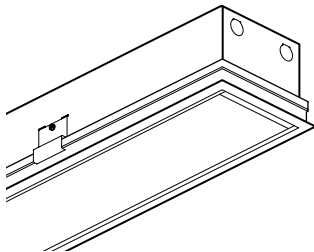
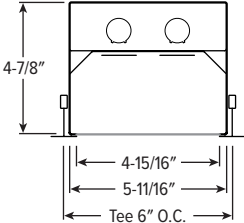

LRX5F

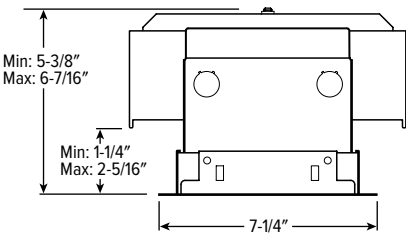

	Recommended Ceiling Opening
2'	6-5/8" x 24"
4'	6-5/8" x 48"
6'	6-5/8" x 72"
8'	6-5/8" x 96"

For continuous row mounting, add 24" for each additional 2' of row length.

AC LRX5 W/ RJ45 PWR/CONTROL

Includes (2) XPD T2P G RJ45 Connectors pre-wired to the luminaire

